

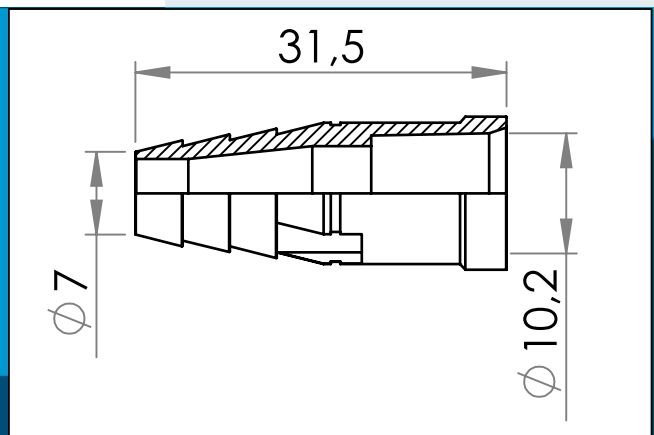

carmo
Your partner in plastic components

09-742 PVC Connector, Barbed for medical tubing

For use with tubing approx. $\varnothing 9,5$ (3/8") mm OD, for internal bonding, with built in tube stop. Outlet tube approx. $\varnothing 6,3 - \varnothing 11$ mm ID



Nominal measurements in mm

For use with tubing approx. $\varnothing 9,5$ (3/8") mm OD, for internal bonding, with built in tube stop. Outlet tube approx. $\varnothing 6,3 - \varnothing 11$ mm ID

Barbed PVC connectors are typically used for medical and Urine bags.

Materials: PVC
Std. packaging: 1 x 10.000
Fits with: 09-542

Interested in other colors or materials? Please call for quote...



Carmo A/S, Hoejvangen 19, DK-3060 Espergaerde, Denmark
T: +45 4912 2100, F: +45 4912 2199, E: denmark@carmo.dk
www.carmo.dk

More info <http://www.carmo.dk/en/medical-components/connectors-caps/09-742/>

All geometrical dimensions and functional information are indicative. (Unless tolerances are specified). Carmo is not responsible for misprints and technical changes.
2024-06-15 19:16:15 UTC