

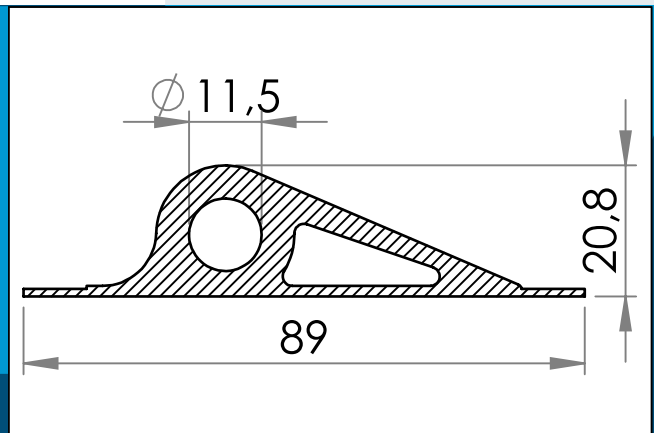

carmo
Your partner in plastic components

05-148 PVC Attachment Point w. square base, 12/90 mm

High frequency weldable PVC line support, with a rectangular base. Can be used with up to 11mm diameter rope or shock cord.



Nominal measurements in mm

High frequency weldable PVC line support, with a rectangular base. Can be used with up to 11mm diameter rope or shock cord. Suitable for low temperature usage and UV stabilised.

PVC, 51 Shore D nominal hardness. Suitable for low temperature usage and UV stabilised.

Materials: PVC
Std. packaging: 1 x 800
Related products: 05-146, 05-246, 05-247, 05-248

Interested in other colors or materials? Please call for quote...



Carmo A/S, Hoejvangen 19, DK-3060 Espergaerde, Denmark
T: +45 4912 2100, F: +45 4912 2199, E: denmark@carmo.dk
www.carmo.dk

More info <http://www.carmo.dk/en/technical-components/cleats/attachment-points/05-148/>

All geometrical dimensions and functional information are indicative. (Unless tolerances are specified). Carmo is not responsible for misprints and technical changes.
2022-10-01 07:09:59 UTC